

*YOUR BEST SOLUTION PARTNER*



- ❖ ANESTHESIA
- ❖ ANESTHESIA VENTILATOR
- ❖ PATIENT MONITOR
- ❖ BABY INCUBATORS
- ❖ VENTICAB (COVID-19) CABIN
- ❖ HFNC O2 THERAPY
- ❖ STAINLESS STEEL HOSPITAL EQUIPMENTS (CCSD)
- ❖ MOBIL CLINICS

# ABOUT US

PURESENSE MED, is an organization serving from 1997 until today in the medical device industry. In 1997, the technical service firms entering the sector since 1999, these services as well as medical device design, production, engages in import and export activities. Anesthesia devices and components, Patient Monitors, Baby Incubator, HFNC O2 Therapy, Mobil Clinics and Stainless Steel Hospital Equipments makes the production of company has become one of the leading companies in the world. ISO 9001:2015, ISO 13485:2016, CE, TSE Service Qualification, trademark registration documents with the company by production of medical devices both in Turkey and aims to contribute to human health in the world.



## **We combined our medical sensitivity with stainless.**

Our company has been producing anesthesia devices, patient monitors, high flow oxygen therapy devices and mobile clinics for 24 years. We are excited to share our knowledge and experience with you, our valuable solution partners, throughout this period.

Our company, which has an expert staff that has been producing since the day it was founded; It can cut all kinds of quality sheets and pipes with laser, bend them, and process all kinds of quality raw materials in machining. Since our company is a manufacturer of medical devices, FULL QUALITY ASSURANCE system is applied. Our company, which is a manufacturer of operating room and intensive care devices, aims to increase its production to different dimensions with the same precision in stainless.





❖ ANESTHESIA.....	5
❖ ANESTHESIA VENTILATOR.....	9
❖ PATIENT MONITOR.....	11
❖ BABY INCUBATORS.....	14
❖ VENTI-CAB NEGATIVE PRESSURE CABINET.....	19
❖ HFNC O2 THEPAPY.....	24
❖ STAINLESS STEEL HOSPITAL EQUIPMENTS.....	28
❖ MOBIL CLINICS.....	41
❖ OUR MACHINE PARK.....	62





# Anesthesia Machines

# Anesthesia Machines Future FX

## Product Details

TMS Future FX is designed to be your personal anesthesia assistant . Fresh gas flow meter on the device's electronic distribution system ( electronic mixer unit) . The device is tested and proven design with modern reliability for today's increasingly complex healthcare environment, your service offers a comprehensive first-class ventilation technology . Volume-controlled ventilation in Device (VCV), pressure control ventilation (PSV), volume or synchronized in pressure mode intermittent mandatory ventilation (SIMV / VCV and SIMV / PCV) , pressure regulated volume controlled ventilation (PRVC) modes are standard . Heated canister system (CO<sub>2</sub> absorption system) with the patient circuit and the canister internal condensation is eliminated at the maximum level occurred in the system.

## Ventilation

Device 12.1 " color touch screen has like. In the tidal volume control screen, airway pressure, I / E ratio, minute volume, breath count, peak and plateau pressure can be monitored At the same time , all parameters can be adjusted via the touch screen .

## Monitoring

The monitoring options are available in various configurations and options. Follow the standard parameters except the 8 types of gases (O<sub>2</sub>, EtCO<sub>2</sub>, N<sub>2</sub>O, ENF , ISO, DES, SEV, HAL) gas is available as an optional module that allows viewing .

## Vaporizer

TMS Sigma Delta vaporizers do not require service. The device has an aluminum chassis weighs about 5 kg. The maximum volume of 250 mL, 35 mL is the minimum volume, maximum margin of error is  $\pm 10\%$  . The flow rate is 0.2 to 15 l / min can be adjusted. Operating temperature range is between 15-35°C . In the vaporizer to prevent the use of two gas simultaneously locking (interlock ) is. Key Type Fast Type and includes 3 types of pool filling adapter in accordance with the user's request, including Type.



## Maxi 2200 AV-S

### Product Details

TMS Maxi 2200 (AV- S) it is designed to be your personal anesthesia assistant . Dual selectateck (Back- bar ) system, oxygen priority N<sub>2</sub>O / O<sub>2</sub> / Air flow meter system (ORC-Oxygen Ratio Controller), automatic N<sub>2</sub>O cut-off system (Antihipoks Protection ), audible - visible O<sub>2</sub> alarm system, flush the system (25-75 l / min) 3 drawer unit, 1 l / 2 liters of CO<sub>2</sub> absorber (canister) system, flue gas exhaust system is fitted as standard.

### Ventilation (AV-S)

AV- S anesthesia ventilator 8.4 " color , has a touch screen. Software-controlled, multi-modal a ventilator that. Ventilator, cycle time , volume / pressure is controlled and limited pressure. The ventilator has a fresh gas compliance compensation system and fixed at 25% of the inspiratory time, inspiratory pause has a user-selectable option. Ventilation parameters can be monitored numerically and numerically. The supplied volume-controlled ventilation (VCV), pressure control ventilation (PCV), pressure support ventilation (PSV), synchronized intermittent mandatory ventilation (SIMV) ventilation synchronized mandatory minute (SMMV) and improved patient is presented to the user's service as assisted spontaneous mode standards.

### Monitoring

On the monitoring screen tidal volume, airway pressure, minute volume, I / E ratio, the number of breath, peak airway pressure, plateau pressure and percentage of oxygen can be followed in numerical or numerically.

### Vaporizer

TMS Sigma Delta vaporizers do not require service. The device has an aluminum chassis weighs about 5 kg. The maximum volume of 250 mL, 35 mL is the minimum volume , maximum margin of error is  $\pm 10 \%$  . The flow rate is 0.2 to 15 l / min can be adjusted. Operating temperature range is between 15-35°C. In the vaporizer to prevent the use of two gas simultaneously locking ( interlock ) is. Key Type Fast Type and includes 3 types of pool filling adapter in accordance with the user's request, including Type



## Point

### Product Details

TMS Point anesthesia apparatus, magnetic resonance imaging (MRI) has been designed to work in harmony with environment. The device provides the user with the possibility of manual and automatic ventilator. The device N<sub>2</sub>O / O<sub>2</sub> flow meter (O<sub>2</sub> priority), the CO<sub>2</sub> absorber (canister) system, a fully automatic air ventilation and gas delivery system features. Selektatec one cone type or types of these models are attaching opportunity vaporizer device .

### Ventilation

Nuffield 200 models available with an optional device that can be achieved with automatic ventilation, the ventilator. Tidal volume can be adjusted in the range of 50-2000 mL. I: E ratio is 4: 1-1: continuously variable between the two. MRI is designed to be compatible in order to work as a pneumatic ventilator.

### Monitoring

Supplied with the optional Nuffield over 200 ventilator (-20 ) - ( 100 ) cm H<sub>2</sub>O [( -2 ) - ( 10 ) kPa)] is carried by air gauge measurement . Ventilator with inspiratory and expiratory control knobs located on both sides of the I:E ratio and flow control knob and positioned in front of the tidal volume of the device can be easily provided.

### Vaporizer

TMS Sigma Delta vaporizers do not require service. The device has an aluminum chassis weighs about 5 kg. The maximum volume of 250 mL, 35 mL is the minimum volume, maximum margin of error is  $\pm 10\%$  . The flow rate is 0.2 to 15 l / min can be adjusted. Operating temperature range is between 15-35°C. In the vaporizer to prevent the use of two gas simultaneously locking (interlock) is. Key Type Fast Type and includes 3 types of pool filling adapter in accordance with the user's request, including Type.





## AV-S

### Product Details

AV-S anesthesia ventilator 8.4 " color , has a touch screen. Software-controlled, multi-modal a ventilator that. Ventilator, cycle time, volume/pressure is controlled and limited pressure. The ventilator has a fresh gas compliance compensation system and fixed at 25% of the inspiratory time, inspiratory pause has a user-selectable option. Ventilation parameters can be monitored numerically and numerically.

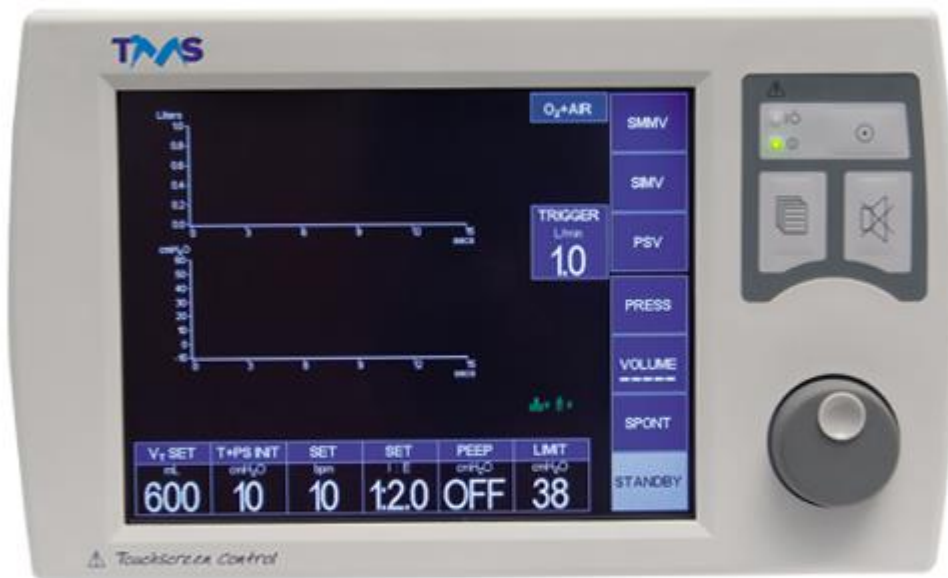

### Ventilation Mods

Volume-controlled ventilation (VCV), pressure control ventilation (PCV), pressure support ventilation (PSV), synchronized intermittent mandatory ventilation (SIMV), synchronized mandatory minute ventilation (SMMV), has developed patient assisted spontaneous mode.

### Parameters that can be set by user

Tidal volume range through the touch screen and navigation buttons on the device 20-1500 mL, 4-100 bpm respiratory rate , I: E ratio of 1: 0.3 to 1 : 8, 4-30 cmH<sub>2</sub>O Peep / off, pressure limit 10-80 cm H<sub>2</sub>O (in Volume mode), 10-50 cm H<sub>2</sub>O (in pressure mode) can be set in the range .

## Anesthesia Ventilator NUFFIELD 200

### Product Details

NUFFIELD 200 anesthesia ventilator models designed for pediatric and adult patients when loop pneumatic drive, an MRI-compatible anesthesia ventilator. It provides ease of use, compact design. It is suitable for repeated use. With Co-Axial ventilator circuit, Ayre 's Tea Circuit, Cycle System (CO2 Absorber System) can be used. Newton Valve newborn and premature infants ultra low tidal volumes can be achieved.



### Parameters that can be set by user

Inspiratory time by the user, by setting expiration time I:E ratio is determined and respiratory rate would be adjusted accordingly. Tidal volume and flow control valve at the front of the ventilator 50 setting-can be adjusted between 2000 ml.

### Followed by user alarms

User device with airline pressure gauge with built-in front panel patient airway pressure (-20) -100 can be monitored in cmH2O range, inspired by timer button on the right and left side of the device and expiration time are monitored.



# PATIENT MONITORS

## TMS FX1

### Product Details

TMS FX1 Hemodynamic patient monitors ; and world leader in ECG technology cardiotechtm next Masimo SET® technology in its standard configuration comes with acutectm hypertension monitoring technology with high consistency. 12.1 inch color TFT with touch screen for ease of use . Monitor IPX1 level and has a water-proof. I kloktm definable alarm levels automatically through intelligent alarm management to reduce false alarms , offers self- set alarm time.

### Parameters

ECG, HR, Sp O2, RESP, NIBP, 2xtemp, 2xibp, Arrhythmia, ST and pacemaker analysis - 120 hours of numerical and graphical trends of all parameters Optional parameters: AG (CO2, O2 , N2O, Enflurane , Isoflurane, Sevoflurane, halothane , desflurane until) the IOC (BIS), the ICG, CO, Nellcor SpO2 , Writer (2 or 3 channel)

### Specifications

Standard display, freezable display screen with large text size, trend display , including the data , the alarm can display the borders of the screen , oxycrg dynamic view screens , bed between display that can display , multi - lead ECG simultaneous display and ;

- Hits:12 lead ECG waveform or waveform channels 7
- Scan speed: 6,25mm/s and 12.5mm/ s 25 mm / s, 50 mm / s
- Indicator: Power indicator light, battery indicator light
- Skin Parameter interface cable , AC power input socket, network interface, an external VGA interface Alternative screen , SD Card and USB outputs
- Trend time: 1-120 hours
- Alarms: high and low thresholds are adjustable by the user audible and visual color-coded alert
- Network to create: links to the Central monitoring systems
- Recorder: Built-in thermal printer (optional) - Paper width 50 mm
- Battery: Lithium -ion battery / rechargeable battery Plug & Play : 4000 The maximum 12-hour charge, to operate continuously for 4 hours





## TMS FX2

### Product Details

TMS FX2 Hemodynamic patient monitors; and world leader in ECG technology cardiotechm next Masimo SET® technology in its standard configuration comes with acutectm hypertension monitoring technology with high consistency. 17.1 - inch diagonal color TFT with touch screen ease of use. Monitor IPX1 level and has a water-proof.

### Parameters

ECG, HR, SpO2, RESP, NIBP, 2xtemp, 2xibp, Arrhythmia, ST and pacemaker analysis-120 hours of numerical and graphical trends of all parameters Optional parameters: AG (CO2, O2 , N2O, Enflurane , Isoflurane, Sevoflurane, halothane, desflurane until) the IOC (BIS), the ICG, CO, Nellcor SpO2, Writer (2 or 3 channel)

### Specifications

Standard display, freezable display screen with large text size, trend display, including the data, the alarm can display the borders of the screen, oxycrg dynamic view screens, bed between display that can display, multi-lead ECG simultaneous display and;

- Hits: 12 lead ECG waveform or 8-channel waveform
- Scan speed: 6.25 mm /s and 12.5 mm /s 25 mm /s, 50 mm/s
- Indicator : Power indicator light, battery indicator light
- Skin : Parameter interface cable, AC power input socket, network interface, an external VGA interface, USB, SD Card, Nurse Call , Defibrillator Output.
- Battery: Lithium-ion battery / rechargeable battery Plug & Play : 4000 mA maximum 12 hour charge, to operate continuously for 4 hours
- Trend time: 1-120 hours
- Alarms: high and low thresholds are adjustable by the user audible and visual color-coded alert
- Network to create : Central monitor system connections
- Recorder: Built-in thermal printer (optional) - Paper width 50 mm
- Waves: 2 channels Recording mode : Manual, alarm during time - defined , etc.
- Print speed: 25 mm/s , 50 mm/s





# BABY INCUBATORS

# MAGIC LOGGIA M

## Product Details

- 6" monochrome LCD screen which all parameters can be monitored,
- Sensor module technology,
- 1 and a half hours continuous monitoring in case of power failure
- The skin temperature of the twins can be measured and monitored at the same time
- Large beds for twin babies
- 72 hours trend
- Height adjustment
- Trendelenburg and reverse trendelenburg mechanism
- X Ray Cassette holder
- USB Ports
- Digital scale (optional)
- LED phototherapy device can be added (optional)
- Servo-controlled oxygen concentration module (optional)



## MAGIC LOGGIA U

### Product Details

- 10.1" colored LCD screen which all parameters can be monitored,
- 360° rotatable drawer and platform,
- Height adjustable VH unit,
- 4 lockable wheels,
- IV Pole,
- Monitor stand,
- External tocuh screen,
- Surfaces easy to clean/sterilize





# Spare Parts

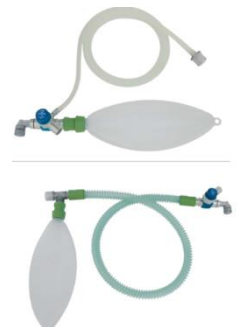

## Spare Parts

Spare parts such as O<sub>2</sub>-AIR Blender, all mechanical parts of baby incubators, all connectors and jacks in anesthesia devices, Selectetic (Back-bar) system, Canister system, Flowmeter system, Exhaust system, APL valve are processed in CNC-Universal lathes. It is assembled and given to assembly or outsourced production after intermediate and final controls are made.



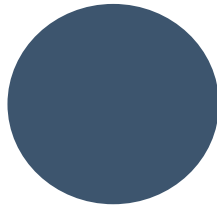
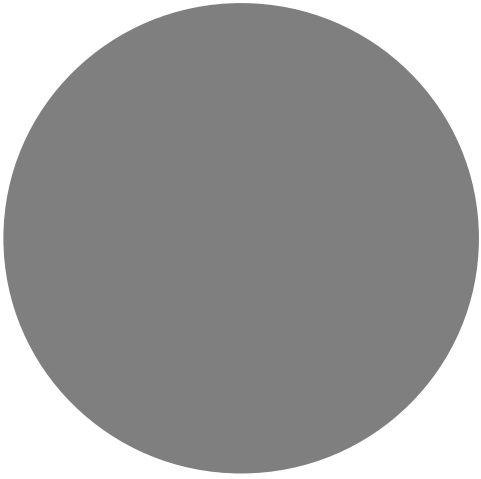

# VENTI-CAB NEGATIVE PRESSURE BREATHING CABINET

## TMS Venti-cab Negative Pressure Breathing Cabinet

Venti-Cab Negative pressure breathing cabinet has been developed to isolate patients who are at risk of transmitting the disease to the environment by inhalation with COVID-19 and similar aerosol release from the outside environment.

Venti-Cab reduces the risk of contamination to healthcare personnel and other patients during operations with high aerosol release risk such as high flow and/or positive pressure oxygen therapy in areas such as emergency, critical care and intensive care, and ensures safe airway operations.





VENTI-CAB is a practical cabin system consisting of two parts that can be easily mounted on the bed. It continuously cleans the air inside the cabin with its effective filter and fan system that can be used in any environment, easy to carry, easy to clean. The fan motor also has the ability to work with a battery. In this way, it can be used to provide isolation in intra-hospital transfers.

High-risk procedures in terms of aerosol such as high flow and/or pressurized oxygen treatments, nebular treatments, intubation can be performed safely with the Venti-Cab.



With its wide, transparent structure, it allows patients to be followed safely and comfortably. With Grommedler, cable and hose connections can be placed without breaking the insulation. With 6 QT law enforcement can easily be placed around the cabin allows the intervention to the patient.

The patient can be followed up safely in the prone position. The position of the fan motor and absorbent filters are designed to allow direct filtration in the prone position. Thanks to the special design of the Venti-Cab, many interventions such as endotracheal intubation can be performed easily when entering the interior environment including the elbows from the QT arm sleeves.



Thanks to its silicone protective flexible structure in the waist area, it protects the insulation and allows the patient to move easily in the cabin.

The Venti-Cab can be used on any patient bed.

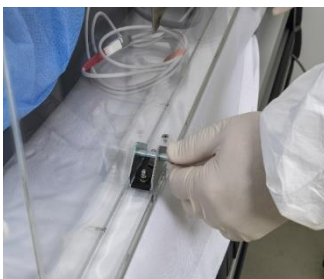



# HIGH FLOW OXYGEN THERAPY (HFNC)



## TMS FM1000 MIX

### Product Details

#### High Flow Nasal Cannula (HFNC)

High flow nasal cannula (HFNC) therapy is an oxygen supply system capable of delivering humidified and heated oxygen (31 to 37 °C) at a flow rate of up to 60L / min to patients with acute respiratory failure across all age groups.

### Technical Specification;

- HFNC device used in neonatal and adult patient groups
- The device has two flowmeter
- Off, 6-60 LPM high flow support
- 1-10 LPM low flow support
- Oxygen adjustment in the range of 21% -100%
- Sound alarm feature in case of pressure difference

### Humidifier;

- 30-40 °C adjustable temperature value
- Provides the opportunity to read the set temperature
- Value from the screen
- Alarm parameter
- Airway: too high / low alarm
- Inside pipeline: too high / low alarm

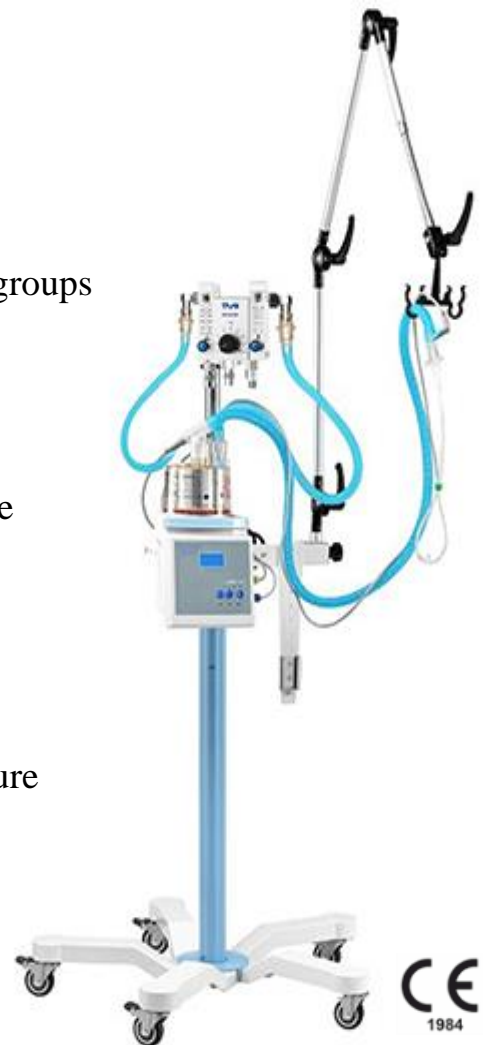

## Product Details

### COVID-19 Mechanical High Flow Nasal Cannula (HFNC)

HFNC (High Flow Nasal Cannula) delivers heated, humidified air and oxygen mixtures at a flow rate of up to 60L / min to the patient through a sealed nasal cannula.

#### Technical Specifications:

- **Lightness:** Supports patient comfort and compliance.
- **Kink resistant:** Provides a smooth air flow for patient safety.
- **Universal connector:** Can be used with many heater wire patient circuits.
- **Softer nose tip:** Provides maximum comfort for patients.
- **More Flexible:** Fully adjustable headband fits snugly to the patient's ears and the interface tube allows it to move comfortably and freely.



360°C Döndürülebilir

## Product Details

### TMS Corona Virus Face Shields PPE (Personal Protective Equipment)

- Protect your face from liquid droplets & splashes
- For key workers, doctors, nurses, pharmacy workers basically all general public can use.
- TMS face shields stop wet droplets, sneezes and coughs going in your eyes, nose and mouth.
- The ultra light (70 gr) TMS Face Mask Shields provides you with the first layer of protection against respiratory droplets, sneezes and airborne particles. TMS Face Mask Shields stop wet droplets going into your mouth, eyes and nose.
- Reusable & Wipeable face shield (with alcohol free disinfectors)
- Adjustable to fit any size head



CE  
1984

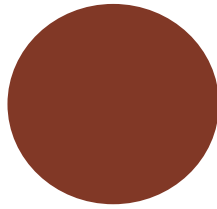
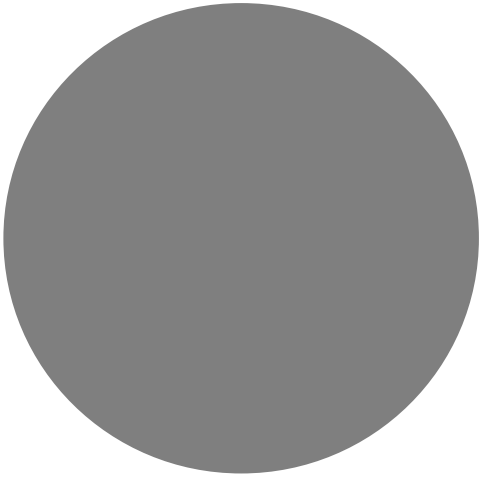

# STAINLESS STEEL HOSPITAL EQUIPMENTS

# Stainless Steel Hospital Equipment

## Tables

Examination Couch



TMS-MS0100

Tool Table



TMS-MS0200

Tool Table With Barriers



TMS-MS0300

Surgical Tool Table



TMS-MS0400

Working Table



TMS-MS0500

Working Table of Drawers



TMS-MS0600

Working Table of 3 Drawers



TMS-MS0601

Working Table With Cabinet



TMS-MS0700

Working Table With Shelves and Drawers



TMS-MS0900

Working Table With Base Shelf



TMS-MS1000

Linen Light Folding Desk



TMS-MS1100

Packing Table



TMS-MS1200



## Stainless Steel Hospital Equipment

### Tables

Moon Table



TMS-MS1300

Mayo Table Hydraulic



TMS-MS1400

Mayo Table Mechanic



TMS-MS1500

Baby Changing Table



TMS-MS1600

### Cabinets

Tool Cabinet



TMS-DL0100

Tool Cabinet with  
Drawers



TMS-DL0200

Operating Room Cabinet



TMS-DL0300

Medicine Cabinet



TMS-DL0400

Chemical Storage  
Cabinet



TMS-DL0500

Material Cabinet



TMS-DL0600

Cleaning Material  
Cabinet



TMS-DL0700

Wall Cabinet



TMS-DL0800

## Stainless Steel Hospital Equipment

### Cabinets

Narcotic Medicine Cabinet



TMS-MS0900

Endoscope Cabinet



TMS-MS1000

Endoscope Cabinet with Dry



TMS-MS1100

Catheter Hanging Cabinet



TMS-MS1200

Hygiene Cabinet



TMS-DL1300

Cap Bonnet, Mask Cabinet



TMS-DL1400

Drying Cabinet



TMS-DL1500

Transfer Window



TMS-DL1600

### Shelving Systems

Wall Shelf



TMS-RF0100

Flat Shelf Perforated



TMS-RF0200

Flat Shelf Fixed



TMS-RF0300

## Stainless Steel Hospital Equipment

### Transport Trolleys

Sterile Transport  
Trolley



TMS-TA0100

Emergency Trolley



TMS-TA0200

Anesthesia Drug Car



TMS-TA0300

Dressing Trolley



TMS-TA0400

Dressing Trolley  
with Cabinet



TMS-TA0500

Medicine and  
Dressing Trolley



TMS-TA0600

Tool Trolley With  
Drawer



TMS-TA0700

Surgical Instrument  
Trolley



TMS-TA0800

Container-Package  
Trolley



TMS-TA0900

Device Stand



TMS-TA1000

Transport Trolley 2  
Floors



TMS-TA1100

Transport Trolley 3  
Floors



TMS-TA1200

## Stainless Steel Hospital Equipment

### Transport Trolleys

ECG & Cautery  
Trolley



TMS-TA1300

Intensive Care Service  
Trolley



TMS-TA1400

Spanç Hanger Trolley



TMS-TA1500

Paper Transport  
Trolley



TMS-TA1600

Lead Apron Trolley



TMS-TA1700

Bathtub Trolley



TMS-TA1800

Basket Transport Trolley  
Quad



TMS-TA1900

Basket Transport  
Trolley Double



TMS-TA2000

Slipper Trolley



TMS-TA2100

Cargo Trolley



TMS-TA2200

Linen Trolley  
Dirty Clean



TMS-TA2300

Linen Trolley  
Fabric



TMS-TA2400

## Stainless Steel Hospital Equipment

### Transport Trolleys

Vertical Laundry  
Trolley



TMS-TA2500

Medical Waste  
Trolley



TMS-TA2600

Tube Transport  
Trolley



TMS-TA2700

### Washing Units

Doctor Hand Washing  
Unit-Single



TMS-YU0100

Doctor Hand Washing  
Unit - Double



TMS-YU0200

Doctor Hand Washing  
Unit - Triple



TMS-YU0300

Stainless Sink



TMS-YU0400

Plaster Preparation  
Table



TMS-YU0500

Baby Washing  
Sink



TMS-YU0600

Endoscope Washing  
Sink



TMS-YU0700

Single Sink  
Bench



TMS-YU0800



## Stainless Steel Hospital Equipment

### Washing Units

Single Sink Bench  
With Cupboard



TMS-YU0900

Single Sink Bench -  
Shelf



TMS-YU1000

Two Sinks Bench



TMS-YU1100

Two Sinks With  
Cupboard



TMS-YU1200

Two Sinks With  
Shelf



TMS-YU1300

Three Sink Bench



TMS-YU1400

Pre-Washing Counter



TMS-YU1700

Ultrasonic Washing  
Counter



TMS-YU1800

Mop Washing Sink



TMS-YU1900

Liquid Waste Sink



TMS-YU2000

Brush holder



TMS-YU2100

Photocell Batikon  
Dispenser



TMS-YU2200

## Stainless Steel Hospital Equipment

### Washing Units

Bathtub Double  
With Stand



TMS-YU2300

Single Tub With  
Stand



TMS-YU2400

Emergency Eye Wash  
Sink



TMS-YU2500

Emergency Body Wash  
Sink



TMS-YU2600

Water Filtering  
Table



TMS-YU2700

### Morgue Unit

1 Capacity Morgue  
Front Loading



TMS-MR0100

1 Capacity Morgue  
Side Loading



TMS-MR0200

2 Capacity 2 Doors  
Morgue Front Loading



TMS-MR0300

2 Capacity 2 Doors  
Morgue Side  
Loading



TMS-MR0400

## Stainless Steel Hospital Equipment

### Morgue Unit

2 Capacity 1 Door  
Morgue Front  
Loading



**TMS-MR0500**

3 Capacity 3 Doors  
Morgue Front Loading



**TMS-MR0600**

3 Capacity 3 Doors  
Morgue Side Loading



**TMS-MR0700**

4 Capacity 1 Door  
Morgue Front Loading



**TMS-MR0800**

4 Capacity 2 Doors  
Morgue Front  
Loading



**TMS-MR0900**

6 Capacity 2 Doors  
Morgue Front  
Loading



**TMS-MR1000**

6 Capacity 6 Doors  
Morgue Front Loading



**TMS-MR1100**

8 Capacity 2 Doors  
Morgue Front  
Loading



**TMS-MR1200**

9 Capacity 3 Doors  
Morgue Front  
Loading



**TMS-MR1300**

9 Capacity 9 Doors  
Morgue Front  
Loading



**TMS-MR1400**

12 Capacity 3 Doors  
Morgue Front Loading



**TMS-MR1500**

12 Capacity 4  
Doors Morgue  
Front Loading



**TMS-MR1600**

## Stainless Steel Hospital Equipment

### Morgue Unit

12 Capacity 12 Doors  
Morgue Front Loading



TMS-MR1700

15 Capacity 15 Doors  
Morgue Front Loading

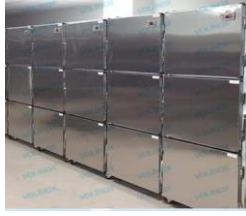

TMS-MR1900

16 Capacity 4 Door Unit  
Morgue Front Loading



TMS-MR2000

20 Kapasiteli 5 Kapı Morg  
Önden Yükleme



TMS-MR2100

Single Wash Package  
Morgue Front Loading



TMS-MR2200

Funeral Transport  
Trolley



TMS-MR2300

Funeral Transport Trolley  
With Cover



TMS-MR2400

Funeral Washing  
Table



TMS-MR2500

Funeral Washing  
Table with Sink



TMS-MR2700

Funeral Loading  
Trolley



TMS-MR2800

## Stainless Steel Hospital Equipment

### Morgue Unit

Cadaver Storage Pool



TMS-MR3100

Chemical Decontamination  
Stretcher



TMS-MR2900

Autopsy Table



TMS-MR3000

Autopsy Table 180 °  
Rotatable



TMS-MR3001

Autopsy Table  
Height Adjustable



TMS-MR3002

Autopsy Table Height  
Adjustable and 180 °  
Rotatable



TMS-MR3002

### Other Hospital Equipments

Waste Bucket



TMS-HG0100

Waste Bucked  
with Foot



TMS-HG0200

Hydraulic Waste Bin



TMS-HG0300

Double Step



TMS-HG0400



## Stainless Steel Hospital Equipment

### Other Hospital Equipments

Single Step



TMS-HG0500

Serum Hanger Metal  
Leg



TMS-HG0600

Serum Hanger Plastic  
Feet



TMS-HG0700

HFNC Transport Stand



TMS-HG0800

TV100 Ventilator  
Carrying Stand



TMS-HG0900

Baby Code



TMS-HG1000

Doctor's Stool



TMS-HG1100

Doctor Stool  
Electric



TMS-HG1200

Stainless Stool



TMS-HG1300

Stainless Steel  
Basket Perforated



TMS-HG1400

Stainless Steel Basket  
Unperforated

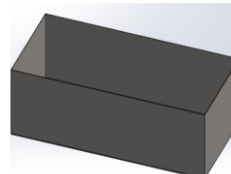

TMS-HG1500

Monitor Strap



TMS-HG1600



# MOBILE CLINICS

## Mobile Clinic and Living Spaces

### Field Hospital

- 1 + 1 Expandable Operation Room
- Patient Transfer Tent



# Mobile Clinic and Living Spaces

## Field Hospital

- 5 + 1 Mobile Hospital
- 2 Expandable Operation Rooms
- 4-bed Intensive Care, Patient Transfer, Lab, Radiology, Triage.

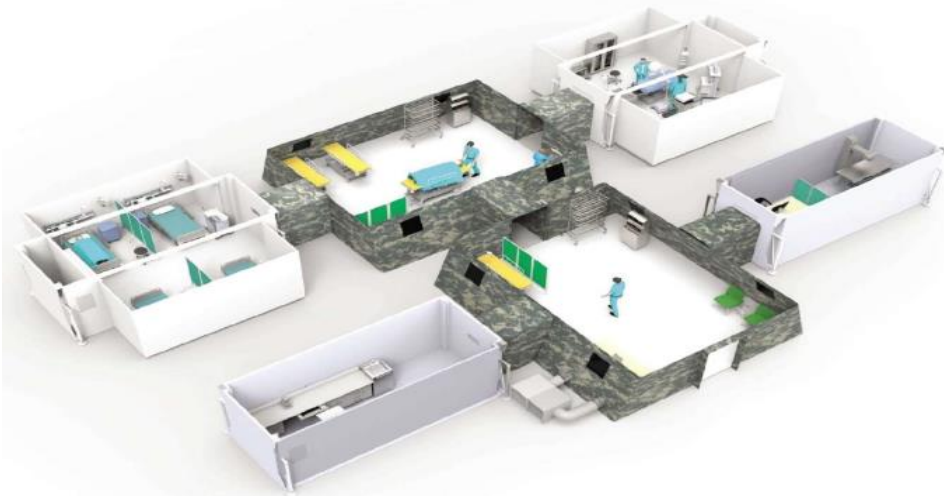

## Mobile Clinic and Living Spaces

### Field Hospital

- 30 Bed Mobile Hospital
- 1 Expandable Container
- 1 Expandable
- 4 Bed Intensive Care Triage, Sterilization, Radiology, Lab.

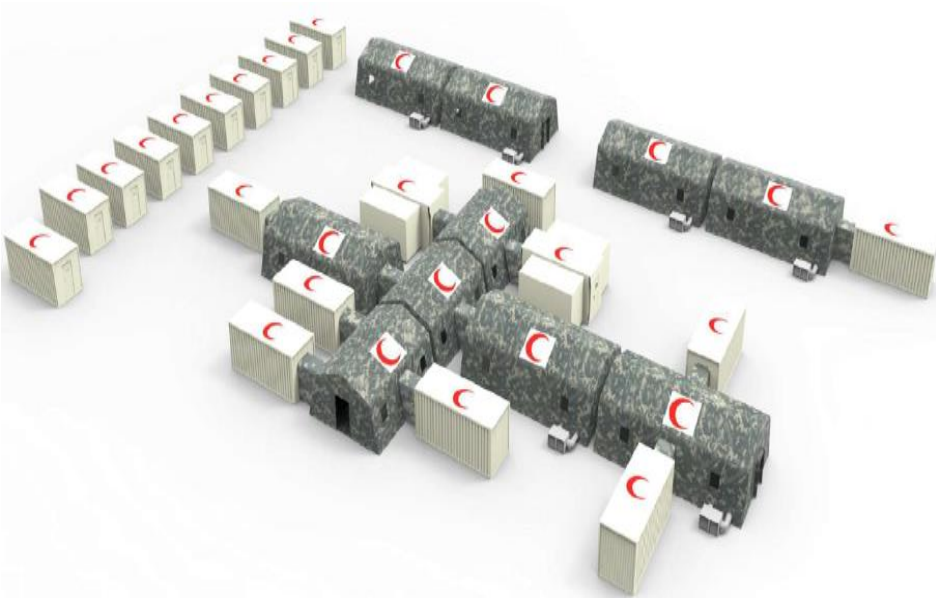



## Mobile Clinic and Living Spaces

### Field Hospital

- 50 Bed Mobile Hospital
- 1 Expandable Container1 Expandable
- 4-Bed Intensive Care and 4-Bed Emergency
- Triage, Sterilization, Radiology, Lab.

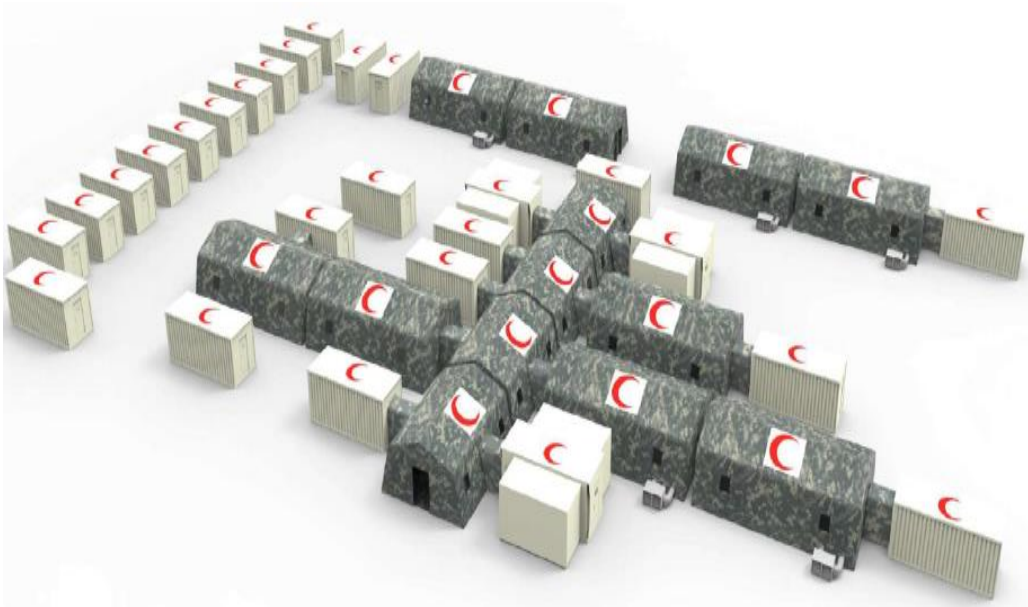

## Mobile Clinic and Living Spaces

### Field Hospital

- 150 Bed Mobile Hospital
- 1 Expandable Container
- 1 Expandable 4-Bed Intensive Care and 4-Bed Emergency
- Triage, Sterilization, Radiology, Lab.

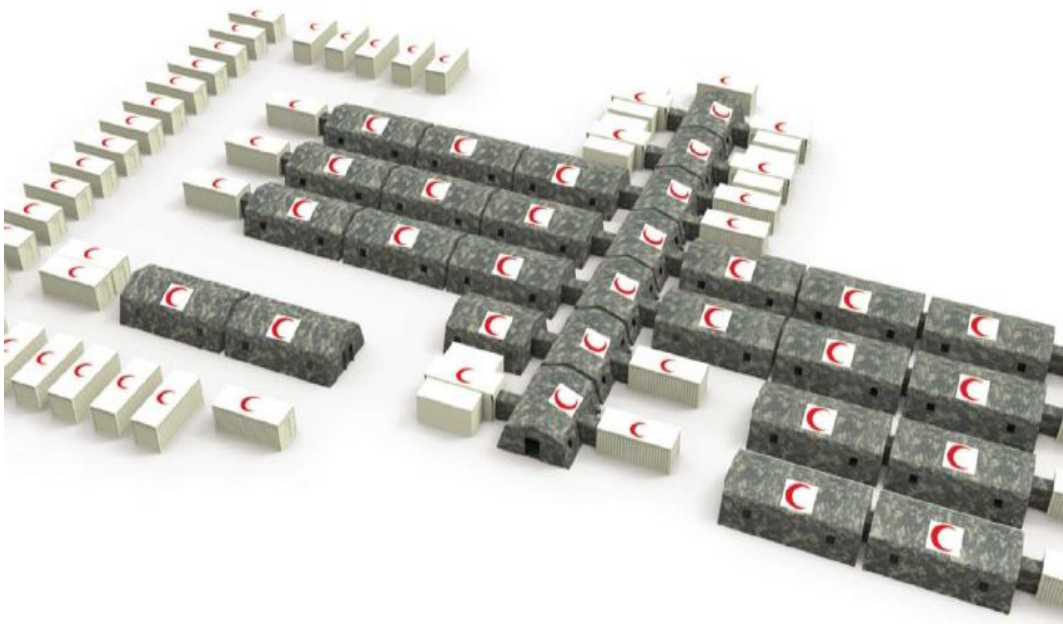

## Mobile Clinic and Living Spaces

### Mobile Eye Clinic



## Mobile Clinic and Living Spaces

### Mobile Eye Clinic





# Mobile Clinic and Living Spaces

## Mobile Dental Clinic

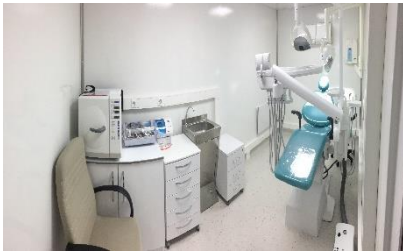



## Mobile Clinic and Living Spaces

### Mobile Dental Clinic



## Mobile Clinic and Living Spaces

Mobile Clinic Vehicle We Designed for Turkish Red Crescent, conducting humanitarian aid work on the border line, opened a mobile clinic in Tel Abyad. With the mobile clinic opened, 500 patients will be served daily. The Turkish Red Crescent, which continues to deliver food, hygiene and other aid materials to those in need, has also started to provide health services with the mobile clinic it has opened in Tel Abyad.

Turkish Red Crescent Mobile Clinic has internal medicine, radiology, pediatrics and laboratory service units. On the other hand, the Red Crescent is also carrying out the repair process of the only hospital in the region damaged by terrorist elements. 500 patients will be tested and treated daily in the mobile clinic where 16 specialist physicians will serve. The location of the mobile clinic may change according to the points that may be needed.

Source of news

<https://www.kizilay.org.tr/Haber/KurumsalHaberDetay/4832>



## Mobile Clinic and Living Spaces

### Turkish Red Crescent Mobile Clinics

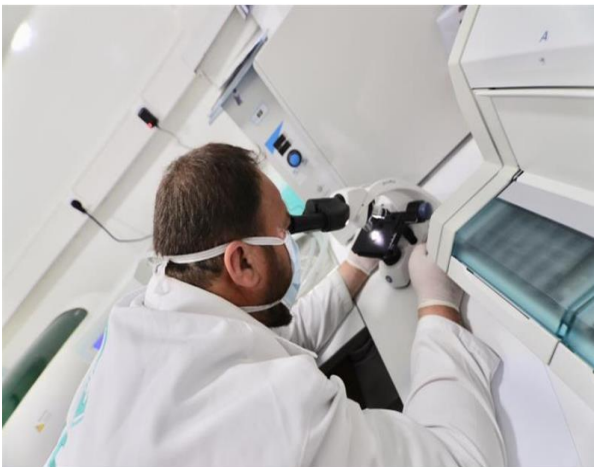



## Mobile Clinic and Living Spaces



## Mobile Clinic and Living Spaces





## Mobile Clinic and Living Spaces



# Mobile Clinic and Living Spaces

## Mobile Blood Bank

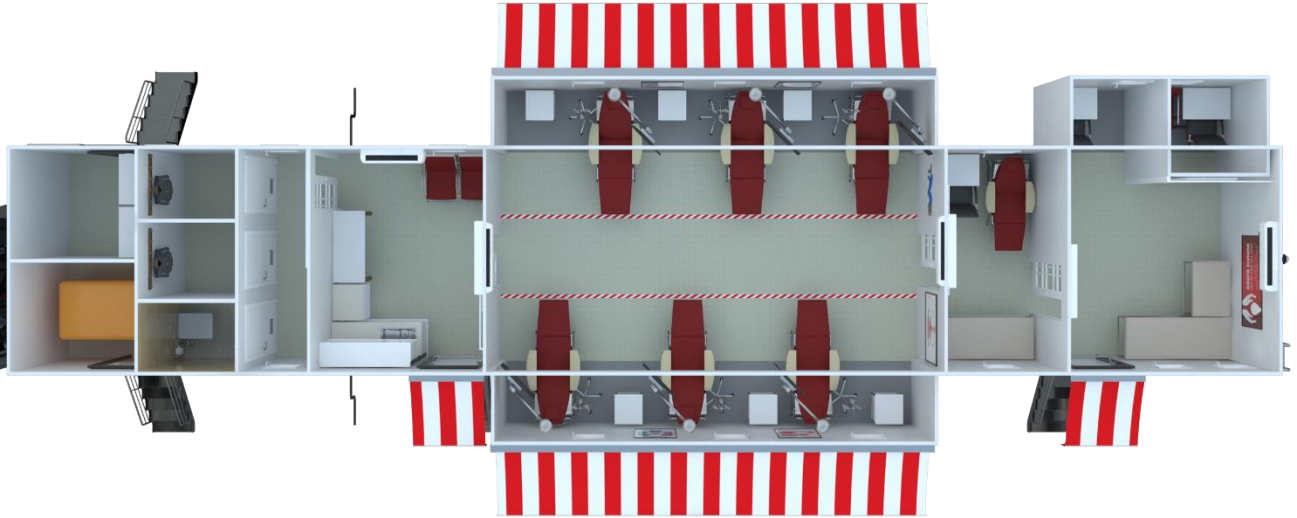

## Mobile Clinic and Living Spaces

### Mobile Bakery





## Mobile Clinic and Living Spaces

### Mobile X-RAY



# Mobile Clinic and Living Spaces

## Mobile Operating Room

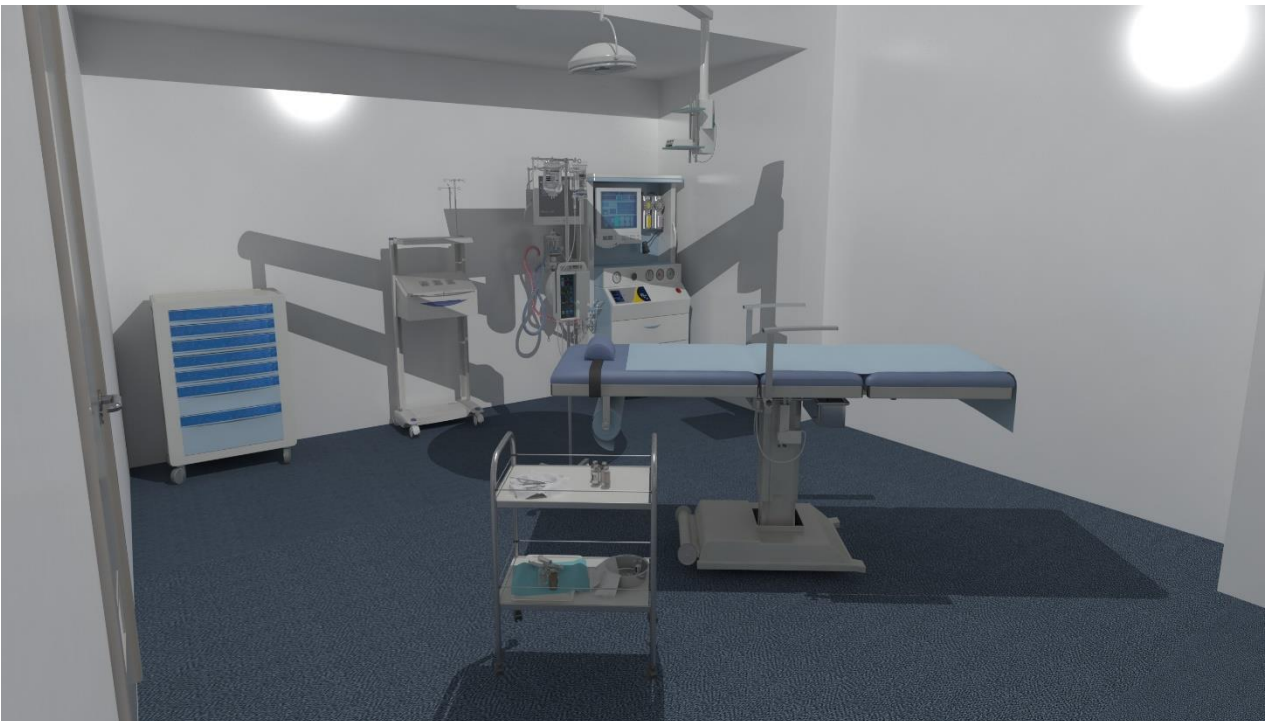



## Mobile Clinic and Living Spaces

### Mobile Operating Room and ICU



## Mobile Clinic and Living Spaces

### Mobile Playground





# OUR MACHINE PARK





## **HD-F3015 Fiber Sheet Laser**

Durma Fiber Laser Cutting Machines come to the fore with their faster cutting and energy efficiency especially compared to CO2 lasers.

## **Durma HD-TC60170 Pipe Laser Cutting Machine**

It is a "high speed" 2D and 2.5D cutting machine used for cutting pipe (maximum diameter 170 mm) and profile (maximum square  $120 \times 120$  mm, rectangular  $150 \times 100$  mm) materials.





## **Durma AD-S Serisi Abkant Presler**

It is designed using modern technologies in order to increase your efficiency and contribute to your precise part bending.

## **PBH 60 PIPE BENDING**









### **HEADQUARTERS & PRODUCTION:**

REŞAT BEY MAH. ORDU CAD. CETIN DEMIR APT. NO:80/1 Adana  
+90 (322) 428 01 06

### **AMERICA:**

244 NE 33 rd STREET OAKLAND PARK, FL 33334

+1 954 999 96 21

E-mail: [info@puresenseproducts.com.tr](mailto:info@puresenseproducts.com.tr)

The products offered for sale may differ from those described or illustrated in this brochure due to subsequent production changes and/or optional non-configurations. Products and specifications are subject to change with prior notice. Please consult PURESENSE MED for the latest information.



[www.puresenseproducts.com.tr](http://www.puresenseproducts.com.tr)